

REV/SHT		DESCRIPTION	DATE	ECN	CHECKED
A	ALL	RELEASE NEW	6/11/13	NEW	JY

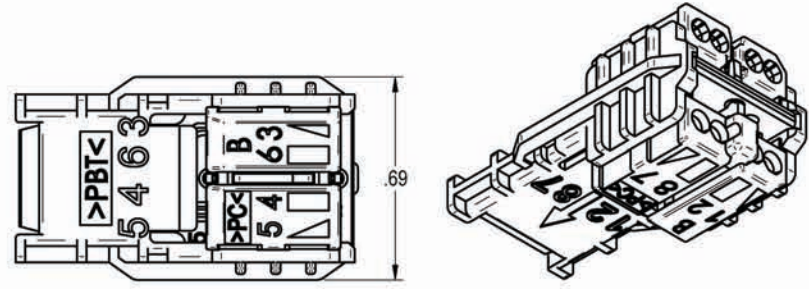

DISTRIBUTED BY: Cables Plus, LLC | 5608 West Marshall St, Richmond, VA 23230  
Toll Free: (866) 678-5852 | Fax: (804) 716-9040 | www.cablesplususa.com



ISOMETRIC VIEW

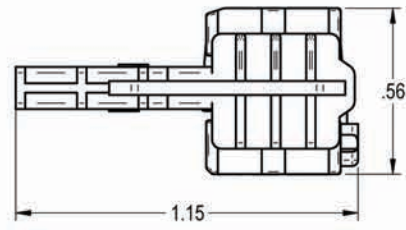

INTERNAL BODY

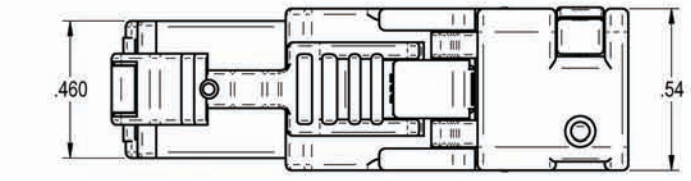
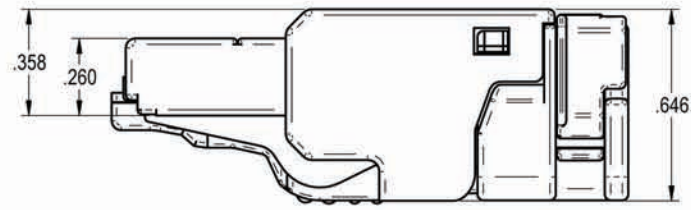
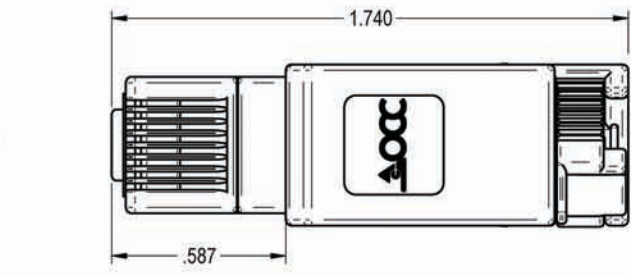

EXTERNAL HOUSING

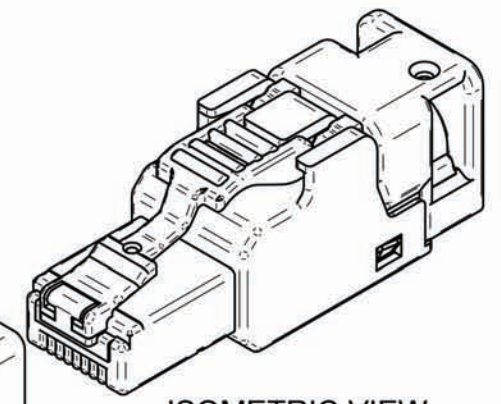
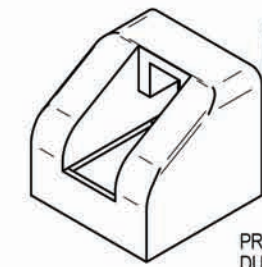
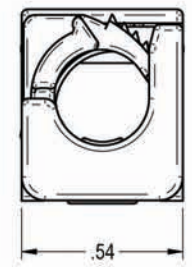

ISOMETRIC VIEW  
PART NUMBER: OCCUFP6A

NOTES: UNLESS OTHERWISE SPECIFIED.

1. PRODUCT APPROVAL REQUIRES CERTIFICATION OF COMPLIANCE TO E.U. RoHS DIRECTIVE 2002/95/EC

2. **PERFORMANCE CHARACTERISTICS:**  
CATEGORY 6<sub>A</sub>: ISO/IEC 11801:2010; CATEGORY 6A:  
ANSI/TIA-568-C.2  
PLUG: IEC 60603-7-41  
LIFE: ≥ 750 MATING CYCLES  
CONTACT FINISH MATERIAL: HARD Au OVER Ni  
HOUSING MATERIAL: BLACK PC UL94-V0  
COPPER CONDUCTOR GAUGE: SOLID: 24 - 22 AWG  
STRANDED: 24/7 - 22/7 AWG  
COPPER CONDUCTOR INSULATION DIAMETER: .043" - .063"  
OVERALL CABLE JACKET DIAMETER: .216" - .335"  
IDC TERMINATION CYCLES: ≤ 4 CYCLES  
TEMPERATURE RANGE: -40°C - 70°C  
POWER OVER ETHERNET PLUS (PoE+) IN ACCORDANCE WITH IEEE 802.3at

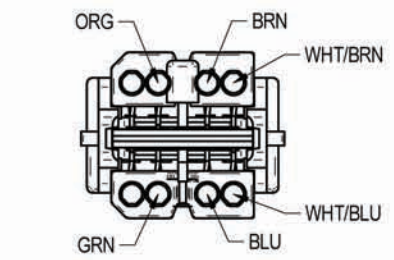

PIN ASSIGNMENT T568B  
ACCORDING TO TIA 568-C.2

UNLESS OTHERWISE SPECIFIED  
DIMENSIONS ARE IN INCHES.  
TOLERANCES: FRACTIONS ±1/32"  
ANGLES ±1/2"  
3 PLACE DECIMALS ±.005"  
2 PLACE DECIMALS ±.01"

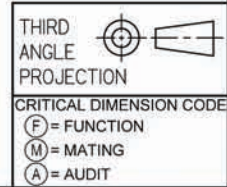

MATERIAL  
SEE NOTES

FINISH  
SEE NOTES

OCCUFP6A	PLUG, CAT6A, T568B, UTP, FIELD TERMINABLE	
OCC PART NO.	DESCRIPTION	
	DWG TITLE <b>PLUG, CAT 6A, T568B, UTP, FIELD TERMINABLE , OCC</b>	
DRAWN	DATE	
CHECKED	DATE	
ENGINEER	DATE	
APPROVED	DATE	
PREVIOUS DWG		
NEXT DWG	FILENAME C111579A.DFT	SCALE: NONE
	SIZE <b>B</b>	DWG NO. <b>C111579</b>
		REV <b>A</b>
		SHEET 1 OF 1